

DTS MULTICAM - SAMPLE CONFIGURATION



CONFIGURATION OVERVIEW – 1.8.3 / 2018.07

© 2010 Arnold & Richter Cine Technik GmbH & Co. Betriebs KG. All rights reserved. This material is provided "as is" for information purposes only without any warranty. ARRI assumes no responsibility with regard to the performance or use of the products or typographical errors or inaccuracies of given information. Product specifications are subject to change without notice. For a full listing of all available components consult the price list.

Multicam Setup

* commercially available

For further details please visit www.dts-dsp.co.uk



onboard camera Monitor

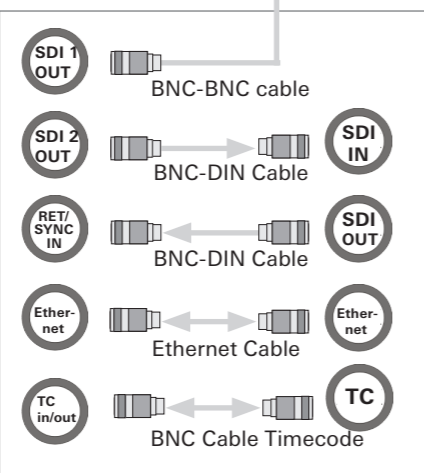

DTS FCA cable set for AMIRA K2.0014814



DTS FCA Fibre Camera Adaptor 12G, K2.0013648

DTS 1820 FCA Lemo Assembly, K2.0014813

DTS 1835A Dual Link 6G Video Input Option K2.0014659

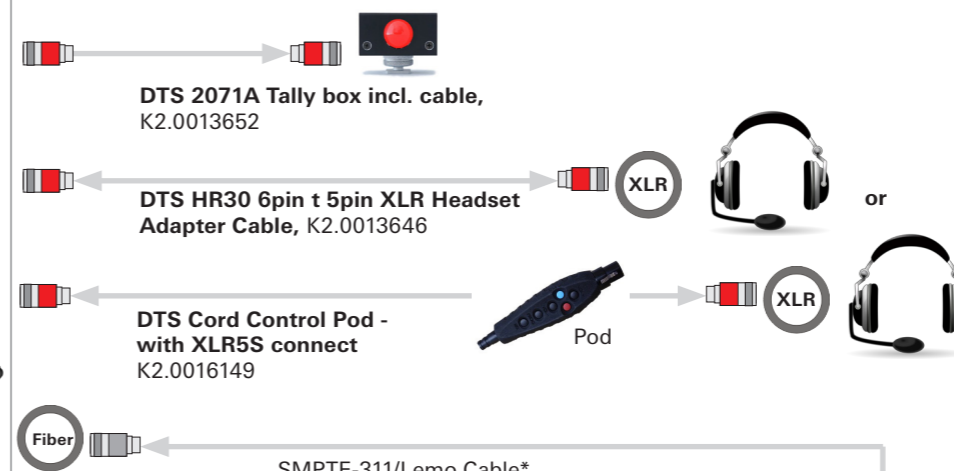

DTS 2071A Tally box incl. cable, K2.0013652

DTS HR30 6pin t 5pin XLR Headset Adapter Cable, K2.0013646

DTS Cord Control Pod - with XLR5S connect K2.0016149

SMPTE-311/Lemo Cable*

DTS FBS cable set: ERI & 1810S power cables K2.0014815

includes: all blue marked cables BNC-DIN cable 5x

DTS 1810-100 19" x 1U Base Shell K2.0013649



DTS FBS 1U Rack Blanking Panel, K2.0019566

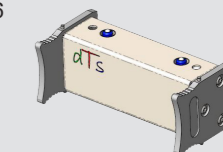

DTS PSU 400 power supply, K2.0013623

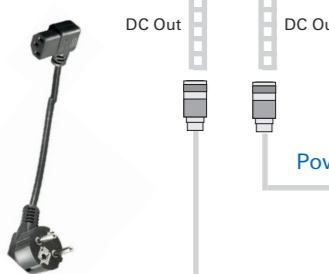

DTS Ethernet Remote Interface ERI, K2.0013650

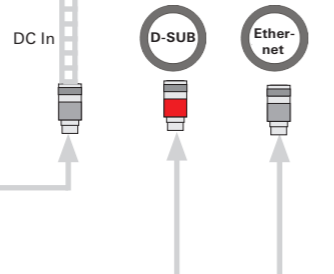

DTS1810 ERI System Utility Tally Cable, K2.0014146

DTS1810 ERI System Utility K2.0019564

D-Sub Cable



Switcher

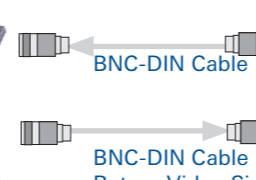

DTS 1810S FBS Lemo Assembly, K2.0014816

DTS FBS Fibre Base Station 12G, K2.0013651

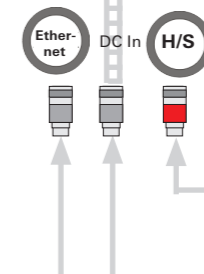

Intercom System

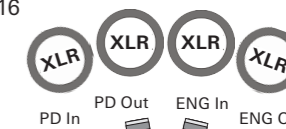

DTS1810S Intercom Audio Cable Assembly, K2.0014145

DTS HR30 6pin t 5pin XLR Headset Adapter Cable, K2.0013646



Remote Control Panel (RCP)

DTS Sony RCP to DTS1840 cable, K2.0013653